

Bus Staging Schedule - 2052 - Final Phase		
Family and Type	Count	
SVA_Parking Space: 13000 x 3500 - 12m Diesel Bus	98	
SVA_Parking Space: 19000 x 3500 - 18m diesel bus	104	
Grand total: 202		

Car Parking Schedule (2052 - Final Phase)		
Type Comments	Count	
Disabled Car Parking	4	
Staff or Visitor Car Parking	36	
Grand total: 40		

Area Schedule (Proposed - Final Phase)			
Name	Level	Comments	Area
Initial Phase			
01 SECURITY	WSS Ground Storey	(For 202 drivers)	54 m ²
02 REST	WSS Ground Storey	(For 202 drivers)	641 m ²
03 DISPATCH	WSS Ground Storey	(For 148 buses)	81 m ²
Initial Phase			776 m ²
Final Phase			
04 ADMIN	WSS Ground Storey	(For 61 buses)	300 m ²
04 ADMIN	WSS First Storey	(For 61 buses)	300 m ²
05 GARAGE	WSS Ground Storey	(For 61 buses)	97 m ²
06 PROCESS	WSS Ground Storey	(For 61 buses)	1656 m ²
06 PROCESS	WSS First Storey	(For 61 buses)	581 m ²
Caboose	WSS Ground Storey	(For 61 buses)	73 m ²
Wash	WSS Ground Storey	(For 61 buses)	73 m ²
Final Phase			3080 m ²
attenuation pond	WSS Ground Storey		976 m ²
			976 m ²
Grand total			4832 m ²

Notes on Phasing:

Initial Phase:

Construction of fencing*, staging area, Security, Rest and Rudimentary Dispatch(160m²) buildings as indicated in layout below as well as limited parking

Final Phase planning:

Admin, Process, Wash, Refueling, Vehicle Garages and escape lane* as indicated below as well as Full Dispatch on top of process building and full parking have been allowed in the design

* escape lane in initial phase subject to budget

* 2 rows of fencing in initial phase subject to budget

* Bonnytown road formalization subject to budget and design development

* Vehicle entry bypass lanes phasing subject to design development

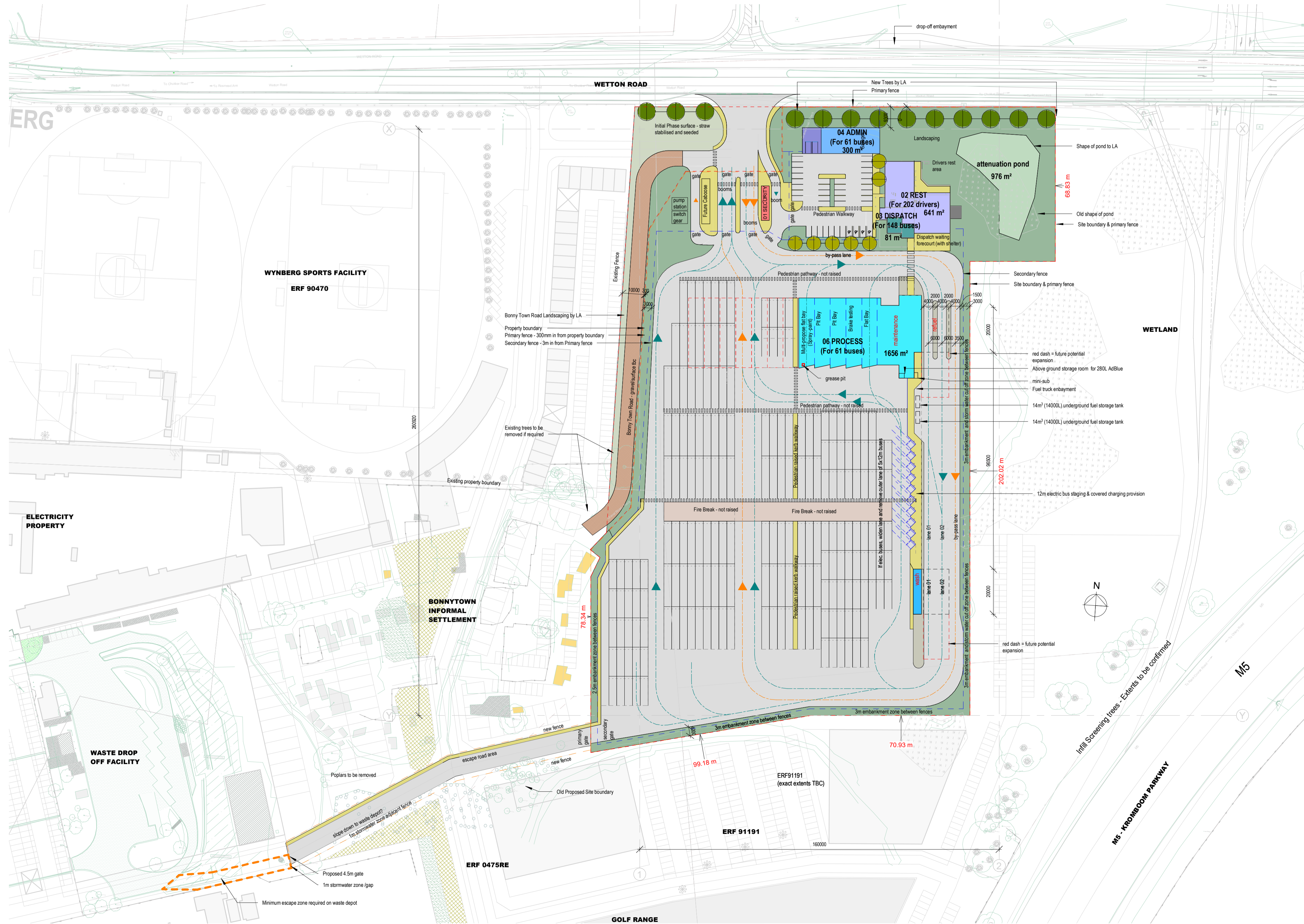

NOTES

- The design on this drawing is copyright and remains the property of SVA International (Pty) Ltd. Reg. No 2011/137280/7
- All work to be carried out in strict accordance with local authority requirements, National Building Regulations, and the S.A.S. standards.
- This drawing may not be scaled. Only figured dimensions and levels may be used.
- All relevant details, levels, and dimensions must be checked on site before commencement of work. Any discrepancies to be reported to the Architect immediately.

REVISIONS

Rev	Date	Issued by	Description
I	2021-02-20	RE	Site boundary
J	2021-02-26	RE	Site Boundary, survey update, dispatch, walkways, bus numbers
K	2021-03-04	RE	Stage 1 report
L	2021-03-13	RE	Phasing drawings, Landscaping
M	2021-03-15	RE	Fire break adjustments
N	2021-03-25	RE	Final Site access arrangement, site boundary at bonnytown
O	2021-04-21	SR	Alternative Entrance Options
P	2021-04-29	SR	In progress for information for consultants input
Q	2021-04-29	SR	In progress for information for consultants input - update

FOR INFORMATION

Client: CITY OF CAPE TOWN
ISIXEKO SASEKAPA
STAD KAAPSTAD

Project: **Wetton Road MyCiti Bus Facility**

Project address: Erven 90470 RE, 90475RE and 91191. Wetton Road, Wynberg.

Drawing: **Final stage site layout(2052)**

Drawing Number: **IRT-SVA-A-WSS-00-DR-11-100**

Project ID	Originator	Role	Volume	Level	Type	Sheet No.
IRT	SVA	A	WSS	00	DR	11-100

Project No.	Scale	Date	Drawn By	Revision No.
CA15061.00	1:1000	2021-04-29	SR	Q